



CREATIVE PIPING SOLUTIONS PVT LTD.

An ISO 9001:2015 and OHSAS Certified Company



ASME
SETTING THE STANDARD

Forged Fittings



Industrial Flanges



Butt-weld Fittings



Fasteners



Branch-olet

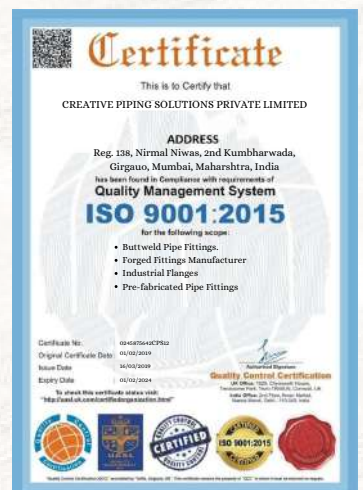

PRODUCT RANGE



BUTTWELD FITTINGS

STAINLESS STEEL: ASTM A403 WP 304 / 304L / 304H / 316 / 316L / 317 / 317L

/ 321 / 310 / 347 / 904L etc

CARBON STEEL: ASTM A234 WPB/A420, WPL3/A420, WPL6/ MSS-SP-75 WPHY

42/46/52/56/62/65/70.

ALLOY STEEL: ASTM A 234 WP1 / WP5 / WP9 / WP11 / WP22 / WP91 etc.

NICKEL ALLOY: Monel, Nickel, Inconel, Hastalloy, Copper, Brass, Bronze, Titanium, Tantalum, Bismuth, Aluminium, High Speed Steel, Zinc, Lead etc.

TYPES: Elbow, Tee, Reducer, Return Bends, Stub-Ends, Cap, Collar, Cross, Insert etc.

SIZE: 1/4" NPS to 48" NPS. (Seamless & Welded)

WALL THICKNESS: Sch.5S to Sch. XXS

STD: ANSI / DIN

More Details Visit: <http://www.creativepipings.com/buttweld-fittings/>



INDUSTRIAL FLANGES

STAINLESS STEEL: ASTM A182 F304 / 304L / 304H / 316 / 316L / 317 / 317L / 321 / 310 / 347 / 904L etc

CARBON STEEL: ASTM A105 /A694 F42 / 46 / 52 / 56 / 60 / 65 / 70 / A350 Lf2, etc.

LOW TEMPERATURE, CARBON STEEL: A333 Gr.3/Gr.6 etc.

OTHERS: Monel, Nickel, Inconel, Hastalloy, Copper, Brass, Bronze, Titanium, Tantalum, Bismuth, Aluminium, High Speed Steel, Zinc, Lead etc.

TYPES: Weldneck, Slipon, Blind, Socket Weld, Lap Point, Spectacles, Ring Joint,

Oriface, Long Weldneck, Deck Flange, RTJ, Flange.

SIZE: 1/2" NPD to 60" NPS.

WALL THICKNESS: 150#, 300#, 400#, 600#, 900#, 1500# & 2500#.

STD: ANSI / DIN / EN / BS / JIS.

For More Details Visit: <http://www.creativepipings.com/industrial-flanges/>



FORGED FITTINGS

STAINLESS STEEL: ASTM A182 F304 / 304L / 304H / 316 / 316L / 317 / 317L / 321 / 310 / 347 / 904L etc

CARBON STEEL: ASTM A105 /A694 F42 / 46 / 52 / 56 / 60 / 65 / 70 / A350 LF2, etc.

ALLOY STEEL: ASTM A182 F2 / F5 / F9 / F11 / F22 / F91 etc.

OTHERS: Monel, Nickel, Inconel, Hastalloy, Copper, Brass, Bronze, Titanium, Tantalum, Bismuth, Aluminium, High Speed Steel, Zinc, Lead etc.

TYPES: Elbow, Tee, Union, Cross, Coupling, Cap, Bushing, Plug, Swage, Nipple, Welding

Boss, Hexagon Nipple, Barrel Nipple, Welding Nipple, Parallel Nipple, Street Elbow,

Hexagon Nut, Hose Nipple, Bend, Adapter, Insert.

SIZE: 1/4" NPS to 4" NPS.

CLASS: 3000#, 6000#, 9000#.

For More Details Visit: <http://www.creativepipings.com/forged-fittings/>



BRANCH-OLET

SPECIFICATIONS: ASTM B 564 / ASTM SB 564

DIMENSIONS: ASTM 16.11, MSS SP-79, 83, 95, 97, BS 3799

SIZE: 1/8"-4" (DN6-DN100)

MATERIAL: Stainless Steel, Carbon Steel, Alloys Steel, Monel, Nickel, Inconel, Hastalloy, Copper, Brass, Bronze, Titanium, Tantalum, Bismuth, Aluminium, High Speed Steel, Zinc, Lead etc.

TYPES: Welding Olet, Sock Olet, Threaded Olet, Lateral Olet, Elbow Olet, Nipple Olet,

SIZE: 1/4" NPS to 4" NPS.

CLASS: 3000#, 6000#, 9000#.

For More details Visit- <http://www.creativepiping.com/forged-fittings/>

Pre-fabricated Pipe Fittings Spool-

Flanged elbow Flanged elbow is flange welded to the end of elbow. It maybe one end or two end. The flanged end will connected to flange directly. The elbow could be according to ASME B 16.9, EN10253 or GOST17375. The flange will be according to ASME B16.5, EN1092 or GOST.

Size : 1/2" to 96"

Pressure : 150# to 2500#

Material : Stainless Steel, Carbon Steel, Alloys Steel, Monel, Nickel, Inconel, Hastalloy, Copper, Brass, Bronze, Titanium, Tantalum,

For More Details Visit: <http://www.creativepipig/pipe-spool/>



Pre-fabricated Pipe Fitting

STAINLESS STEEL: AISI 302, 304, 304L, 316, 316L, 310, 317, 317L, 321, 347, 410, 420, 904L etc

CARBON STEEL: Bare Condition, Galvanized Phosphetised, Cadum Plated, Hot Deep Gavanized, Bloodied, Nickel Chrome Plated etc.

ALLOY STEEL: 4.6, 5.6, 6.6, 8.8, 10.9, & 12.9 / 'R', 'S', 'T' Conditions.

NON FERROUS METAL: Copper, Brass, Aluminium, Titanium, Nichrome, Al. Bronze Phosphoros Bronze, etc

TYPES: Bolt, Nuts, Washer, Anchor Fastener, Stud Bolts, Eye Bolt, Stud, Threaded Rod, Cotter Pin, Socket Screw, Fine Fasteners & Spares, Foundation Fasteners etc.



FASTENERS



Lateral Tee

STAINLESS STEEL: AISI 302, 304, 304L, 316, 316L, 310, 317, 317L, 321, 347, 410, 420, 904L etc

CARBON STEEL: Bare Condition, Galvanized Phosphetised, Cadum Plated, Hot Deep Gavanized, Bloodied, Nickel Chrome Plated etc.

ALLOY STEEL: 4.6, 5.6, 6.6, 8.8, 10.9, & 12.9 / 'R', 'S', 'T' Conditions.

NON FERROUS METAL: Copper, Brass, Aluminium, Titanium, Nichrome, Al.Bronze Phosphoros Bronze, etc

TYPES: Equal Lateral Tee, Reducing Lateral Tee

For More Details Visit: <http://www.creativepiping.com/lateral-tee/>



Hot Induction Bend

Pipe Diameter (O.D): min. 2" (60,3 mm); max 60" (1524 mm)

Radius: min. 100 mm; max. 11000 mm

Wall thickness: max. 200 mm/ 3mm- 40mm / SCH5, SCH10, SCH20, SCH30, SCH40, STD, SCH80, XS, SCH60, SCH80, SCH120, SCH140, SCH160, XXS

Pipe Bend Angle: 0°- 180°

- Pipe Bend Standards: ASTM A403- ASME SA403 – Standard Specification ASME B16.9, ASME B16.25, ASME B16.28, MSS SP-43, ASME B16.49

Production Grades: Carbon Steel, API 5L, ASTM A106 Grade B, Stainless Steel, Alloy Steel, Duplex, Nickel Alloys, Low temperature Steel, Copper, Cupro Nickel, Inconel, Monel, Hastelloy

For More details Visit: <http://www.creativepiping.com/hot-induction-bend>



Split Tee

SPECIFICATION

Standards : ANSI B31.1, B31.3, ANSI B31.4 & B31.8 ASME Sec. VIII Div.1 & 2

Size: 2" TO 48"

Pressure Ratings: 150# TO 2500#

Stainless Steel Split Tee: ASTM A403 F304, F304L, F310, F316, F316L, F317, F317L

Carbon Steel Split Tee: ASTM A234 WPB, A860 WPHY 42, WPHY 46, WPHY 52, WPHY 60, WPHY 65, WPHY 70.

Low Temperature Carbon Steel Split Tee: ASTM A420 WPL3, WPL6

For More Details Visit: <http://www.creativepiping.com/split-tee/>

Standards:

ANSI – B 16.9 ASTM A403 – ASME SA403. API 590-605 ASME B16.9 ASME B16.25, ASME B16.28 , Corrosion Resistant Applications'

Schedule: 5S, 10S, 20S, S10, S20, S30, STD, 40S, S40, S60, XS, 80S, S80, S100, S120, S140, S160, XXS and etc.

Sizes: 1/2" TO 36"(SEAMLESS UPTO 24")(WELDED 8" TO 36")

Materials: Monel, Nickel, Inconel Hastalloy, Titanium, Stainless Steel, Alloy Steel, Carbon Steel

Type: Butt Weld (BW)

Dimension: ANSI B16.9, ANSI B16.28, MSS-SP-43 Type A, MSS-SP-43 Type B, JIS B2312, JIS B2313



Barrel Tee

Manufacturer and Exporter

Buttweld / Socketweld / Threaded Fittings & Flanges

This is introduce ourselves as the most reliable outsourcing partners for manufacturing of butt welding pipe Fittings, socket weld, pipe fittings. Flanges & tubular components in all kinds of steel. Our panel of experienced manufacturers ensures excellent quality Fittings meeting exacting standards of National & International quality.



These Pipe Fitting are manufactured from ferrous metal such as Carbon Steel, Alloy Steel, Low Temperature Carbon Steel & Stainless Steel. Both Seamless and E.R.W. Pipe Fittings are Produced by our special manufacturing process involving either hot or cold forming. We are fully capable of manufacturing Pipe Fittings made to customer's specifications in terms of type, dimensions, material & quantity under any third party inspection.

These Pipe Fittings are perfectly round, rugged, leak proof, corrosion resistant (Where ever required), meeting all the requirements to ASA/BS/DIN/ISI codes. These quality Fittings extend the life of piping systems, facilitate direct pipe welding, permit compact installations & reduce the space necessary for installing a piping network

BUTT-WELD PIPE FITTINGS

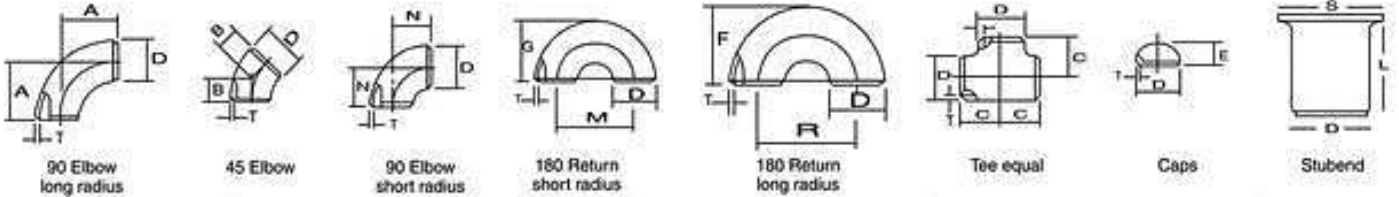

BUTT WELDING PIPE FITTING DIMENSIONAL STANDARD ANSI B-16.9 AND B-16.28 More Details Visit: <http://www.creativepipings.com/buttweld-fittings/>

														
Nominal Pipe Size		Outside Diameter	Center to Face				Back to Face			Center to Center			Length 'L' MS SS P43	
Inch.	mm	D	A	B	C	N	E	F	G	R	M	S	L	L
1/2	15	21.3	38.00	16.0	25.0	—	25.0	48.0	—	76.0	—	35.0	50.8	76.2
3/4	20	26.7	29.00	11.0	29.0	—	25.0	43.0	—	57.0	—	43.0	50.8	76.2
1	25	33.4	38.00	22.0	38.0	25.0	38.0	56.0	41.0	76.0	51.0	51.0	50.8	101.6
1 1/4	32	42.2	48.00	25.0	48.0	32.0	38.0	70.0	52.0	95.0	64.0	64.0	50.8	101.6
1 1/2	40	48.3	57.15	29.0	57.0	38.0	38.0	83.0	62.0	114.0	76.0	73.0	50.8	101.6
2	50	60.3	76.00	35.0	64.0	51.0	38.0	106.0	81.0	152.0	102.0	93.0	63.5	152.4
2 1/2	65	73	95.25	44.0	76.0	64.0	38.0	132.0	100.0	191.0	127.0	105.0	63.5	152.4
3	80	88.9	114.30	51.0	86.0	76.0	51.0	159.0	121.0	229.0	152.0	127.0	63.5	152.4
3 1/2	90	101.6	133.35	57.0	95.0	89.0	64.0	184.0	140.0	267.0	178.0	140.0	76.2	152.4
4	100	114.3	152.0	63.0	105.0	102.0	64.0	210.0	159.0	305.0	203.0	157.0	76.2	152.4
5	125	141.3	190.0	79.0	123.0	127.0	76.0	262.0	197.0	381.0	254.0	186.0	76.2	203.2
6	150	168.3	229.0	95.0	143.0	152.0	89.0	313.0	237.0	457.0	305.0	216.0	88.9	203.2
8	200	219.1	305.0	127.0	178.0	203.0	102.0	414.0	313.0	610.0	406.0	270.0	101.6	203.2
10	250	273.1	381.0	159.0	216.0	254.0	127.0	515.0	391.0	762.0	508.0	324.0	127	254
12	300	323.9	457.0	190.0	254.0	303.0	152.0	619.0	467.0	914.0	610.0	381.0	152.4	254
14	350	355.6	533.0	222.0	279.0	356.0	165.0	711.0	533.0	1067.0	711.0	413.0	152.4	305.0
16	400	406.4	610.0	254.0	305.0	406.0	178.0	813.0	610.0	1219.0	813.0	470.0	152.4	305.0
18	450	457.2	686.0	286.0	343.0	457.0	203.0	914.0	686.0	1372.0	914.0	533.0	152.4	305.0
20	500	508	762.0	318.0	381.0	508.0	229.0	1016.0	762.0	1524.0	1016.0	584.0	152.4	305.0
22	550	559	838.0	343.0	419.0	559.0	254.0	1118.0	838.0	1676.0	1118.0	614.4	152.4	305.0
24	600	610	914.0	381.0	432.0	610.0	267.0	1219.0	914.0	1829.0	1219.0	692.0	152.4	305.0
26	650	660	991.0	406.0	495.0	660.0	267.0							
28	700	711	1067.0	438.0	521.0	771.0	267.0							
30	750	762	1143.0	470.0	589.0	762.0	267.0							
32	800	813	1219.0	502.0	597.0	813.0	267.0							
34	850	864	1295.0	533.0	635.0	864.0	267.0							
36	900	914	1372.0	565.0	673.0	914.0	267.0							



Manufacturing Process:

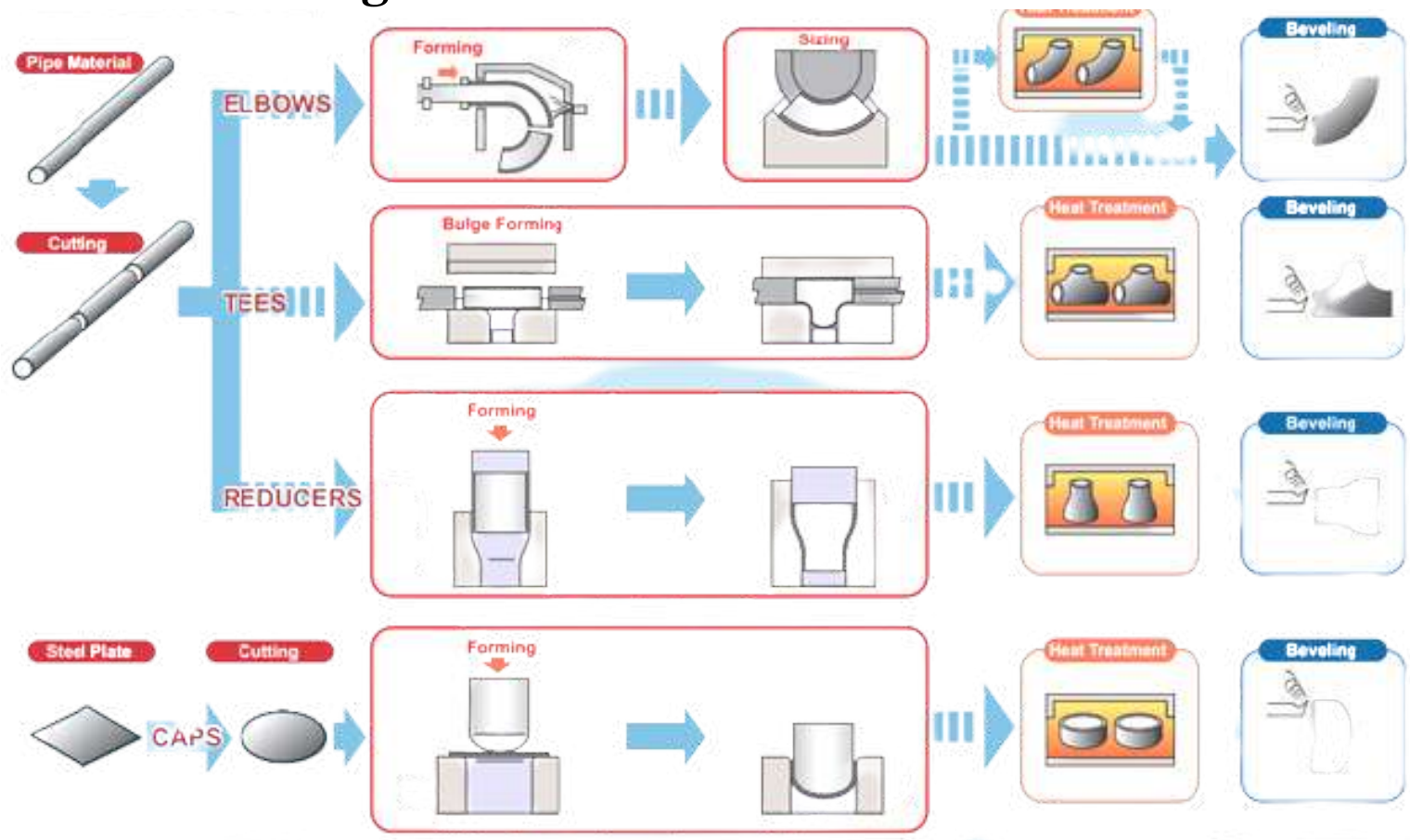

Manufacturing Facilities Gallery;



Heat Treatment



Hydraulic Press



Beveling



Hot Elbow Induction



Tee Pressing



Reducer Pressing



Elbow Dimension



Reducer Beveling



LR Elbow Beveling



Tee Beveling



Penetrant Test



Sand & Shot Blasting



Inspection Instrument



Inspection Instrument



Inspection Instrument



Packing



Packing



Forwading

DIMENSIONAL TOLERANCES AS PER ANSI B 16.9/B 16.28/ MSS SP-43 FOR BUTT WELD FITTINGS

All Fittings					0 deg. And 45 deg. Elbows and Tees	Reducers & Lap Joints Stub Ends	Caps	180 deg Returns	Lap Joint Stub Ends				
Nominal Pipe Size (NPS)	Outside dia at Bewel (1), (2) D	Insidedia at End (1), (2), (3)	Wall Thickness (3)	Center to end Dimension A, B, C, M	Center to Overall Length F, H	Overall Length E	Center to Center Dimension O	Back to Face Dimension K	Alignmen of ends U	Outside Diameter of Lap G	Fillet Radius of Lap R	OutsideDiameter of Barrel	
½ to 2/12		1	0.8	Not less than 87.5% of nominal thickness	2	2	4	7	7	1	+0.1	+0-1	See Table 7 for limiting dimensions
3 to 3/12		1	1.6		2	2	4	7	7	1	+0-1	+0-1	
4	+2	-1	1.6		2	2	4	7	7	1	+0-1	+0.1	
5 to 6	-3	-1	1.6		2	2	7	7	7	1	+0-1	+0.2	
8	+4	-3	1.6		2	2	7	7	7	1	+0-1	+0-2	
10	+4	-3	3.2		2	2	7	10	7	2	+0.2	+0-2	
12 to 18	+4	-3	3.2		2	2	7	10	7	2	+0-2	+0-2	
20 to 24	+6	-5	4.8		3	3	7	10	7	2	+0-2	+0-2	
26 to 30	+7	-5	4.8		3	3	10	--	--	--	--	--	
32 to 48	+7	-5	4.8		5	5	10	--	--	--	--	--	

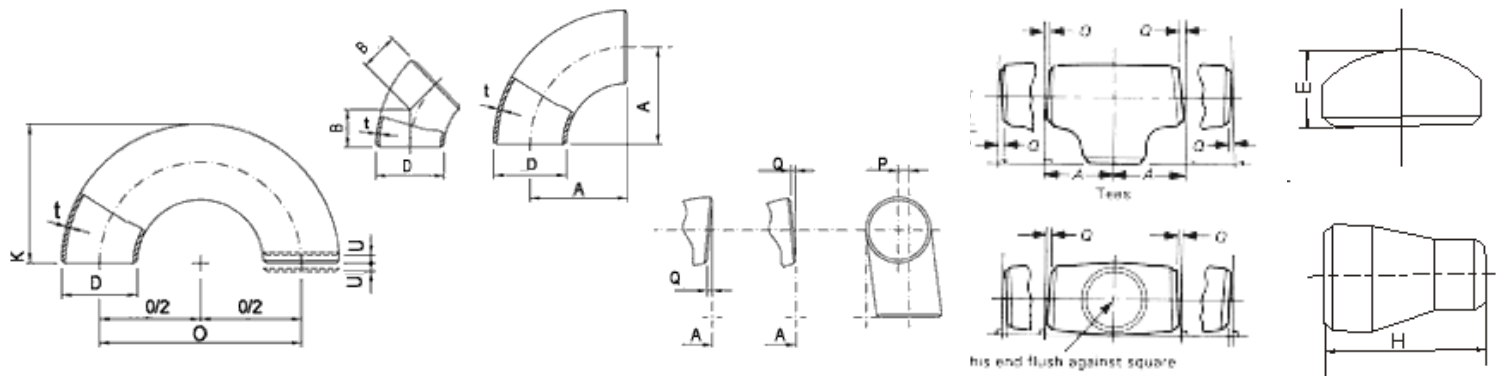

FORGED FITTINGS

ASME B16.11 STANDARDS

FORGED SCREWED FITTINGS TO ANSI SOCKET WELD FITTINGS



DIMENSION IN MM OF FORGED SCREWED FITTINGS TO ANSI B - 16.11 THREADED TO ASA B 2.1

More Details Visit: <http://www.creativepiping.com/buttweld-fittings/>

		90° ELBOWS		TEE		45° ELBOW		UNION		COUPLING		PIPE CAP		BUSHING		HEX HEAD PLUG				
			(DIMENSIONS IN MM)														HALF COUPLING = G/2			
NOM BORE	PIPE O.D.	3000 L.B.S.						COMMON FACTORS						6000 L.B.S.						
		A	B	C	G	H	K	D	E	F	I	J	L	A	B	C	G	H	K	
1/8"	10.3	21	22	17	32	16	19	11	10	40	-	6	-	25	25	19	32	22	-	
1/4"	13.7	25	25	19	35	19	25	16	11	43	3	6	32	29	33	22	35	25	27	
3/8"	17.2	29	33	22	38	22	25	17.5	13	48	4	8	38	33	38	25	38	32	27	
1/2"	21.3	33	38	25	48	29	32	22	15	51	5	8	46	38	46	29	48	38	33	
3/4"	26.7	38	46	29	51	35	37	27	16	57	6	10	51	44	56	33	51	44	38	
1"	33.4	44	56	33	60	44	41	35	19	64	6	10	60	51	62	35	60	57	43	
1 1/4"	42.2	51	62	35	67	57	44	44.5	21	70	7	14	72	60	75	43	67	64	46	
1 1/2"	48.3	60	75	43	79	64	44	51	21	79	8	16	80	64	84	44	79	76	48	
2"	60.3	64	84	45	86	76	48	63.5	22	88	9	17	94	83	102	52	86	92	51	
2 1/2"	73.02	83	102	52	92	92	60	76	27	118	10	21	122	95	121	64	92	108	64	
3"	89.0	95	121	64	108	108	65	89	29	121	10	25	140	106	146	79	108	127	68	
4"	114.5	114	152	79	121	140	68	117.5	32	150	13	25	180	114	152	79	121	159	75	

Manufacturing Process and Facilities Gallery:



Bar Cutting



Forging



Forged Elbow



Forged Tee



Forged Plug



Drilling



Lathe Drilling

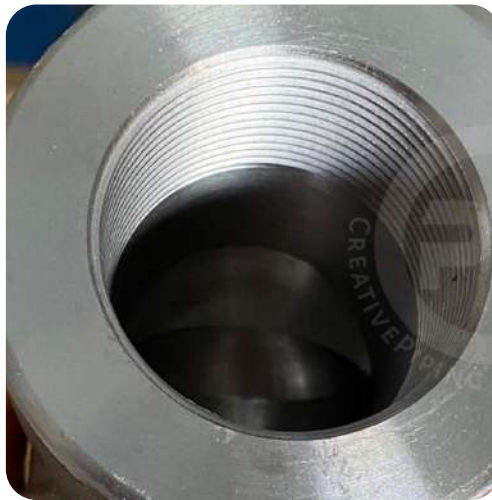

Threading



Inspection Instrument



Packing



Damage Protect



Forwading

FLANGES

ANSI / EN / DIN / BS / JIS / UN
/ AEI TYPE FLANGES STAINLESS STEEL



*Quality
Matters*



For Dimension Visit:

<http://www.creativepiping.com/industrial-flanges/>

Note: This Diagram illustrates the Correct Position but not Necessarily the Correct Number of Bolt Holes

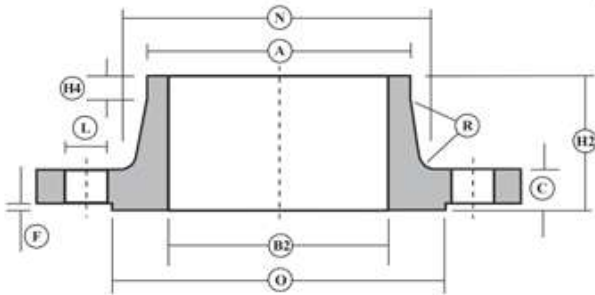
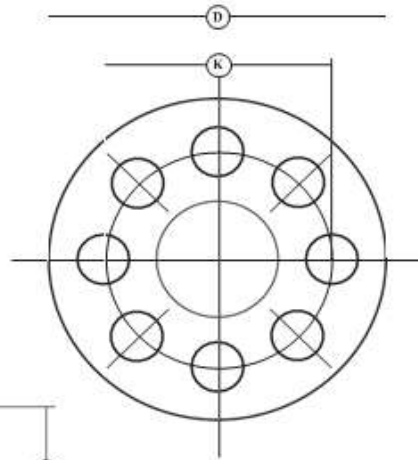

Steel Welding Neck
Flange

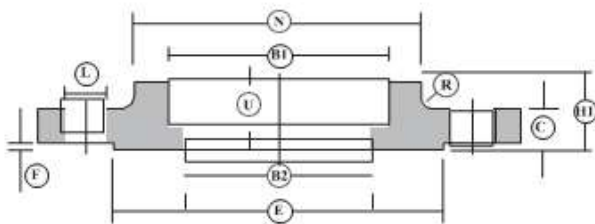

Socket Welding
Flange

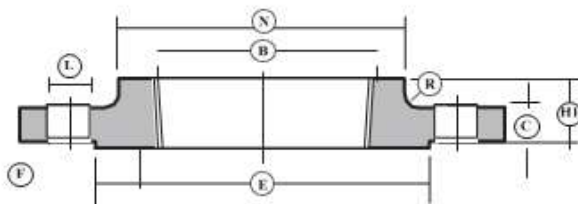

Screwed Boss
Flange

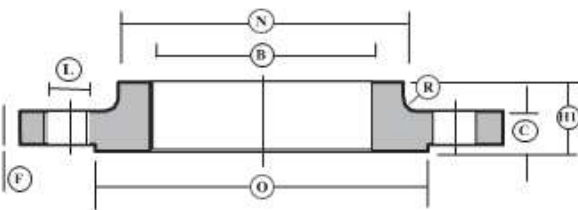

Slip-on Boss
Flange

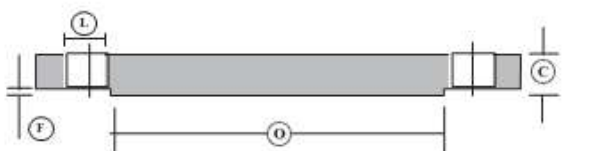

Steel Plate Blind
Flange

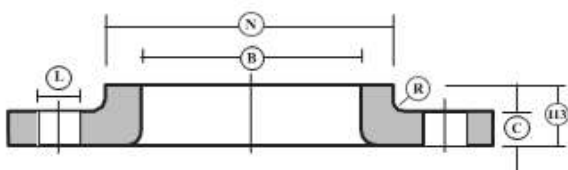

Lapped Flange



Manufacturing Process of Flanges

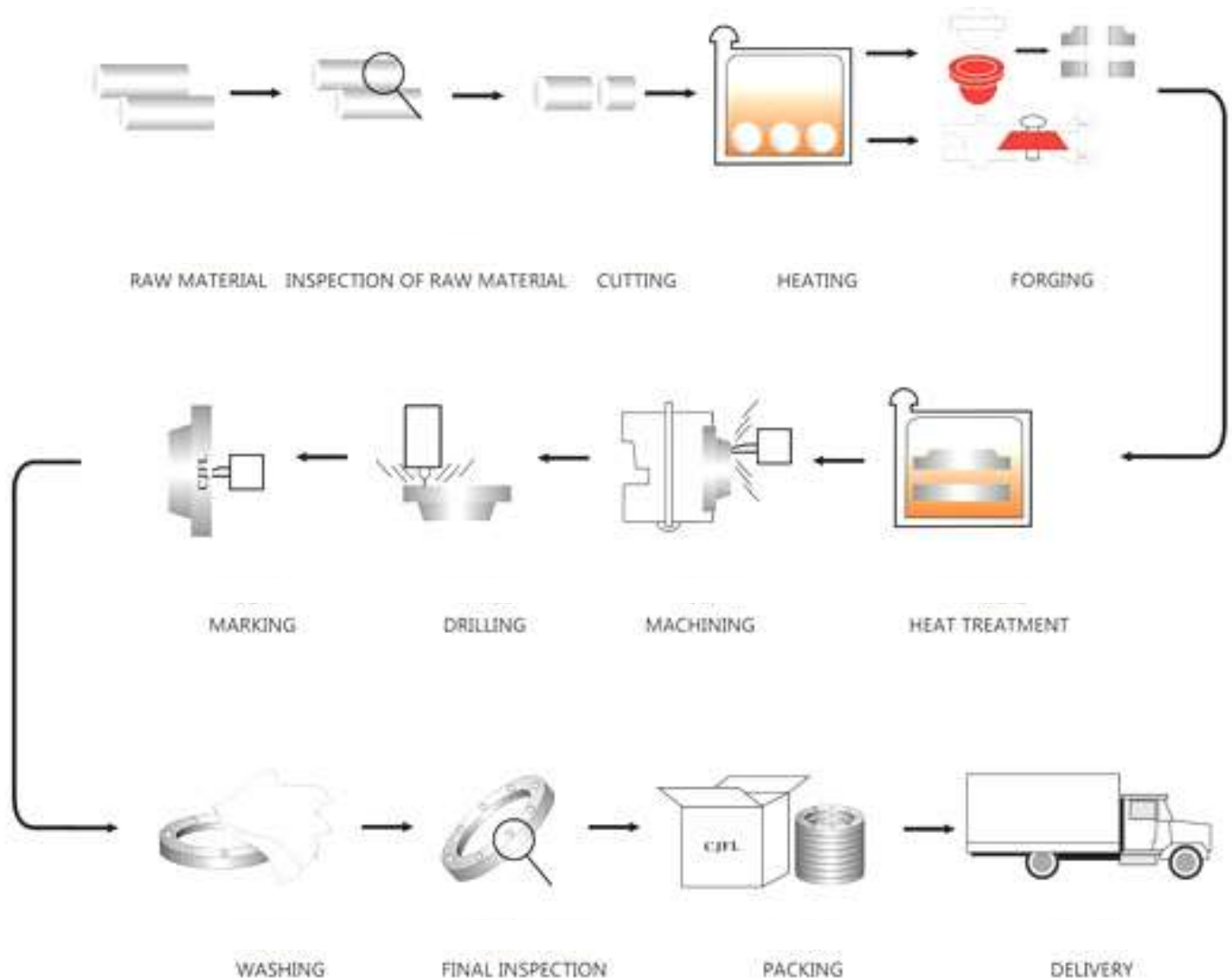

Forging



Heat Treatment



Ring Rolling



CNC Machining



Drilling



CNC Machining



Penetrant Test



Marking



Damage Protect

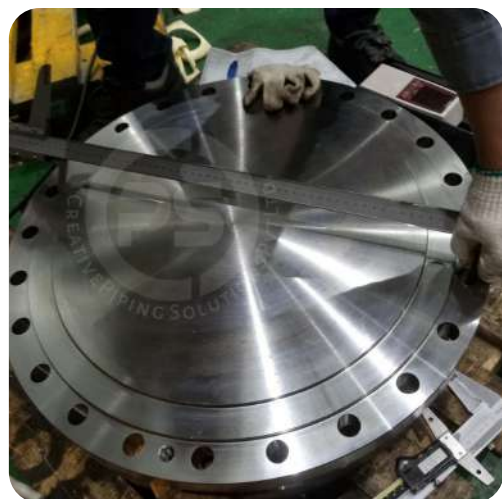

Inspection



Packing



Forwading

Branch Outlets Fittings



THREADED OUTLETS

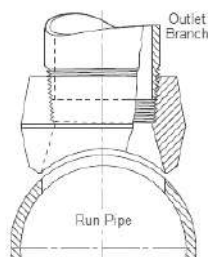
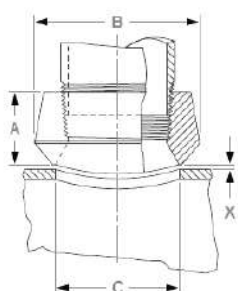

SOCKET-WELD OUTLETS

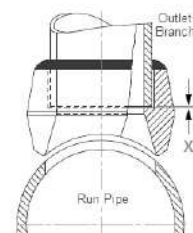
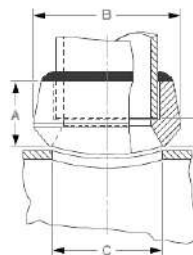

Outlet Size NPS	Dimensions					
	Class 3000			Class 6000		
	A	C	Weight	A	C	Weight
1/8	3/4	.269	0.07	1-1/8	.157	0.15
1/4	3/4	.364	0.12	1-1/8	.250	0.30
3/8	13/16	.493	0.16	1-1/8	.359	0.30
1/2	1	.622	0.27	1-1/4	.464	0.48
3/4	1-1/16	.824	0.36	1-7/16	.612	0.81
1	1-5/16	1.049	0.59	1-9/16	.815	1.30
1-1/4	1-5/16	1.380	0.84	1-5/8	1.160	1.54
1-1/2	1-3/8	1.610	1.00	1-11/16	1.338	1.97
2	1-1/2	2.067	1.53	2-1/16	1.687	5.01
2-1/2	1-13/16	2.469	2.66	2-11/16	2.125	6.19
3	2	3.068	3.72	2-11/16	2.624	7.36
3-1/2	2-1/8	3.548	4.40	-	-	-
4	2-1/4	4.026	7.05	3-5/16	3.438	14.02
5	2-5/8	5.047	9.46	3-11/16	4.313	20.03
6	2-11/16	6.065	14.03	4-1/8	5.187	29.36

Outlet Size NPS	Dimensions					
	Class 3000			Class 6000		
	A	C	Weight	A	C	Weight
1/8	3/4	.328	0.07	1-1/8	.157	0.15
1/4	3/4	.438	0.12	1-1/8	.250	0.30
3/8	13/16	.563	0.16	1-1/8	.359	0.30
1/2	1	.703	0.21	1-1/4	.464	0.42
3/4	1-1/16	.906	0.36	1-7/16	.612	0.71
1	1-5/16	1.141	0.59	1-9/16	.815	1.25
1-1/4	1-5/16	1.469	0.84	1-5/8	1.160	1.53
1-1/2	1-3/8	1.688	1.00	1-11/16	1.338	1.91
2	1-1/2	2.188	1.72	2-1/16	1.687	4.83
2-1/2	1-13/16	2.563	2.90	2-11/16	2.125	6.19
3	2	3.188	4.24	2-11/16	2.624	7.36
3-1/2	2-1/8	3.688	4.40	-	-	-
4	2-1/4	4.188	6.91	3-5/16	3.438	14.02
5	2-5/8	5.275	9.46	3-11/16	4.313	20.03
6	2-11/16	6.313	14.03	4-1/8	5.187	29.36

STANDARD & EXTRA HEAVY BUTT-WELD OUTLET

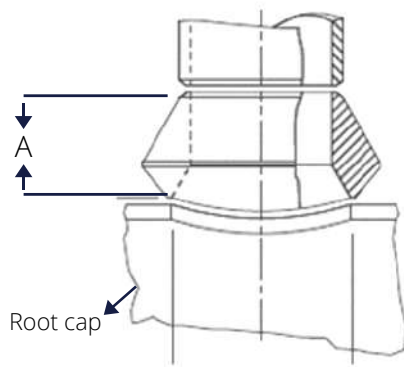

SCHEDULE 160 & DOUBLE EXTRA HEAVY BUTT-WELD OUTLET

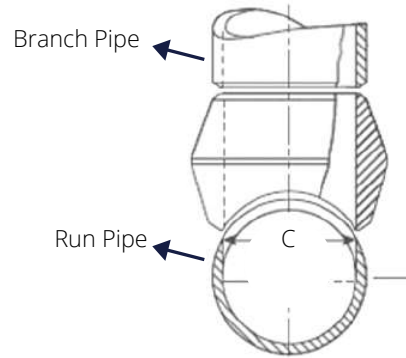

Inches	A	C	WEIGHT	A	C	WEIGHT	A	C	C	WEIGHT
1/8	5/8	.269	.08	5/8	.215	.10				
1/4	5/8	.364	.08	5/8	.302	.08				
3/8	3/4	.493	.15	3/4	.423	.15				
1/2	3/4	.622	.18	3/4	.546	.20	1-1/8	.466	.252	.23
3/4	7/8	.824	.25	7/8	.742	.31	1-1/4	.614	.434	.65
1	1-1/6	1.049	.50	1-1/16	.957	.55	1-1/2	.815	.599	.78
1-1/4	1-1/4	1.380	.80	1-1/4	1.278	.90	1-3/4	1.160	.896	1.16
1-1/2	1-5/16	1.610	1.00	1-5/16	1.500	1.10	2	1.338	1.100	1.60
2	1-1/2	2.067	1.75	1-1/2	1.939	1.75	2-3/16	1.689	1.503	1.95
2-1/2	1-5/8	2.469	2.50	1-5/8	2.323	2.28	2-7/16	2.124	1.771	3.02
3	1-3/4	3.068	3.82	1-3/4	2.900	3.50	2-7/8	2.624	2.300	5.75
3-1/2	1-7/8	3.548	5.10	1-7/8	3.364	4.75				
4	2	4.026	6.20	2	3.826	5.00	3-7/16	3.438	3.152	9.56
5	2-1/4	5.047	8.00	2-1/4	4.813	8.50	3-11/16	4.313	4.063	12.65
6	2-3/8	6.065	11.50	3-1/16	5.761	15.00	4-1/8	5.189	4.897	25.25
8	2-3/4	7.981	22.00	3-7/8	7.625	35.00	*			
10	3-1/16	10.020	37.00	3-11/16	9.750	46.00	*			
12	3-3/8	12.000	44.00	4-1/16	11.750	63.00	*			
14	3-1/2	13.250	63.00	3-15/16	13.000	72.00	*			
16	3-11/16	15.250	76.00	4-3/16	15.000	102.00	*			
18	3-13/16	17.250	100.00	4-3/8	17.000	130.00	*			
20	4	19.250	112.00	4-11/16	19.000	163.00	*			
24	4-9/16	23.250	210.00	5-1/2	23.000	271.00	*			
26	4-11/16	25.250	245.00	5-3/4	25.000	325.00	*			
30	5-3/8	29.250	375.00				*			
36	5-3/8	35.250	498.00				*			
48	5-13/16	47.2502	1125.00				*			

LATERAL & ELBOW CONNECTIONS

(for 90 Degree Long Radius Pipe Elbows)

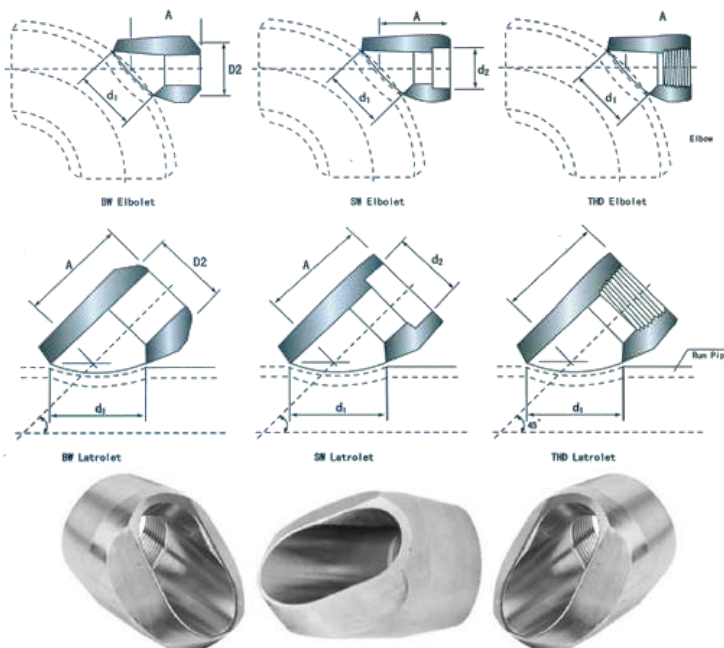

OUTLET SIZE NPS	Dimensions E		WEIGHT
	STANDARD	EXTRA HEAVY	
1/4	1-5/8	1-5/8	0.49
3/8	1-5/8	1-5/8	0.50
1/2	1-5/8	1-5/8	0.52
3/4	1-7/8	1-7/8	1.00
1	2-1/4	2-1/4	1.26
1-1/4	2-1/2	2-1/2	1.39
1-1/2	2-11/16	2-11/16	1.53
2	3-1/8	3-1/8	2.76
2-1/2	3-7/16	3-7/16	4.70
3	3-7/8	3-7/8	6.54
4	4-3/4	4-3/4	12.31
6	6-1/4	7-1/16	24.25
8	7-3/4	8-7/8	60.00
10	9-3/16	9-15/16	90.50
12	10-1/2	11-7/2	121.00

QUALITY POLICY

We are committed to achieve even-increasing levels of customers satisfaction through continual improvements in the quality of our products and services.

This will be achieved by our commitment to:

- Deliver products to customers in the right quantity on time, every time.
- Provide compelling solutions to ensure that our customer succeed.
- Continue updating our technical competence.
- Enhance the expertise of our people by periodic training.
- continuous review and updating our systems.



CREATIVE PIPING

Quality Management Department



Inspection under following agencies & as per clients requirements.

THIRD PARTY
Inspection



APPLICATION INDUSTRY



- PHARMACY INDUSTRIES
- FOOD INDUSTRIES
- OIL & GAS INDUSTRIES
- TEXTILE INDUSTRIES
- CEMENT INDUSTRIES
- REFINERY PLANTS
- POWER PLANT
- FIRE FALLING SYSTEMS

- CHEMICAL
- FERTILIZERS
- PAPER & PULP MILLS
- SUGAR INDUSTRIES
- WATER PIPING
- SYSTEMS BEVERAGE
- INDUSTRIES
- ENGINEERING